

Syringe carriage assembly (4 pages)

Figure 1010-22

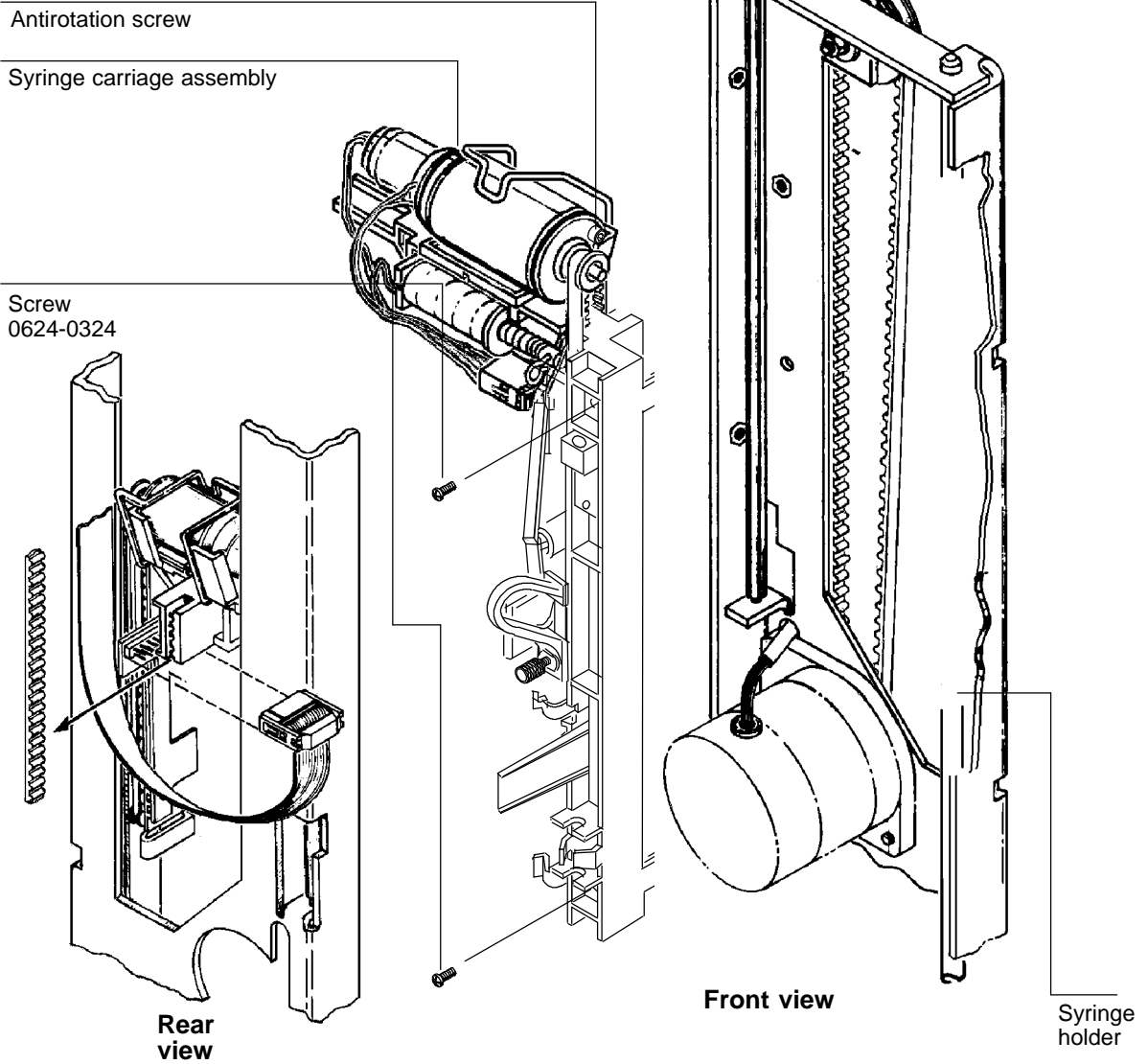
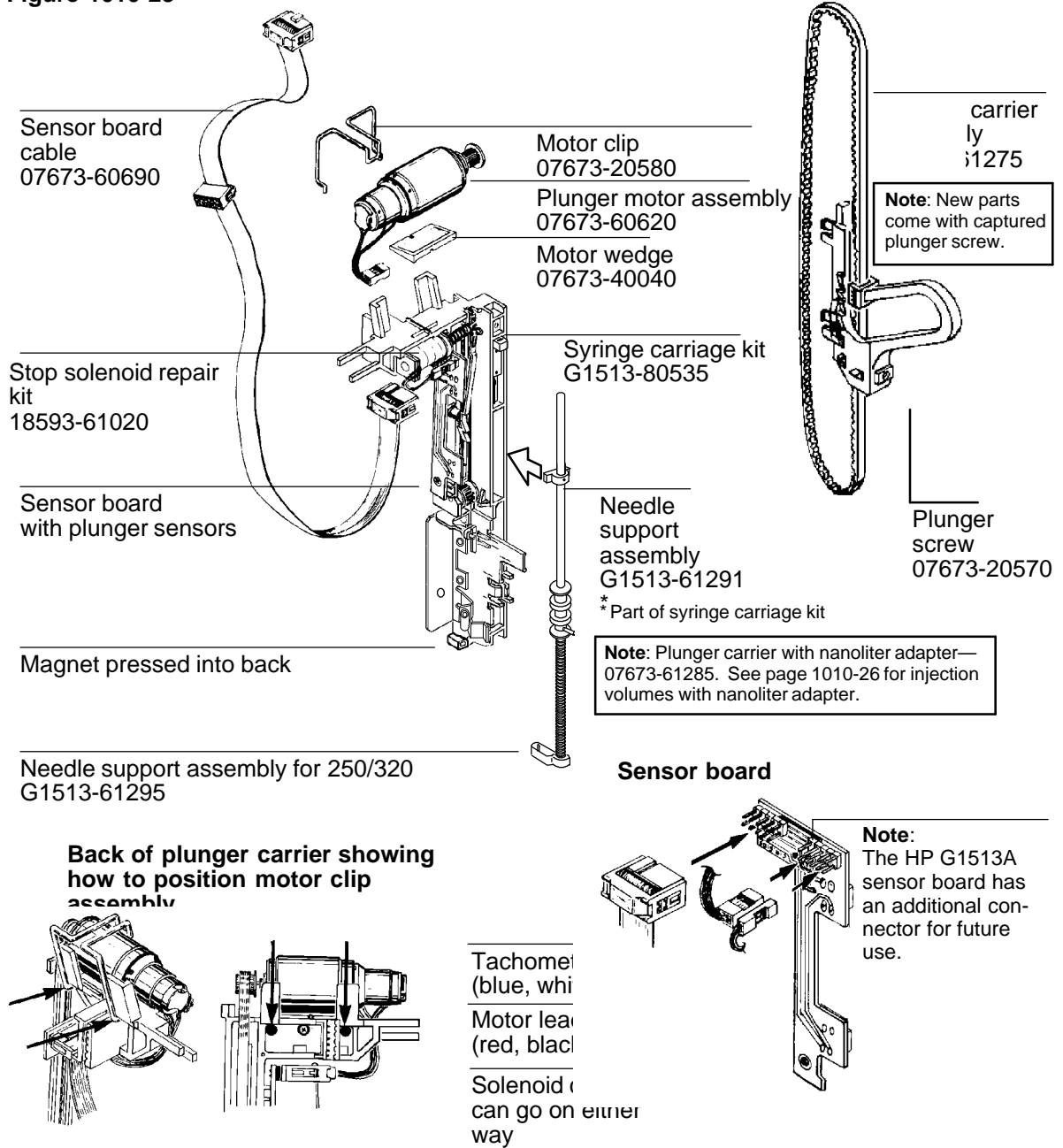

Figure 1010-23



250/320 automation upgrade kit

For HP G1513A, use HP 18599T.

Setting	Sample Volume	Standard Injection		Nanoliter Injection	
	Syringe Size	5 μ l	10 μ l	5 μ l	10 μ l
1		0.5	1.0	0.1	0.2
2		1.0	2.0	0.5	1.0
3		1.5	3.0	1.0	2.0
4		2.0	4.0	1.5	3.0
5		2.5	5.0	2.0	4.0

Figure 1010-24

The foot of the needle support contains a replaceable needle guide made of plastic material. This guide should be replaced periodically. For high throughput labs, we recommend changing the guide every 6 months or 5000 injections.

Caution:

Matching the needle support and the cool on-column septum nut is crucial. Using the wrong septum nut or needle support will result in syringe needle bending problems and syringe carriage errors.

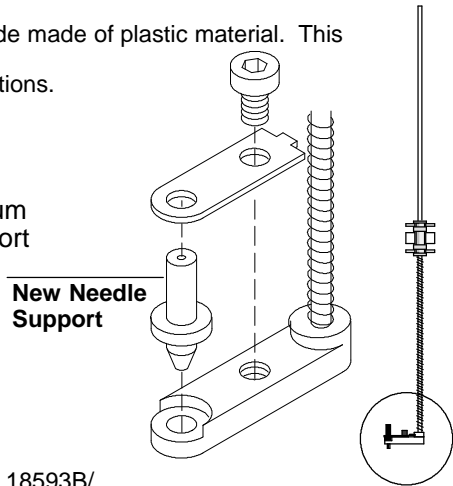

Needle support kit for preventive maintenance
07673-61340

Mounting the Injector over an On-Column Inlet

The following table reviews the different parts for mounting an HP 18593B/ HP G1513A (post mount) injector over a cool on-column inlet. It also shows what is required for injection onto 0.32-mm to 0.25-mm i.d. columns.

Type of GC/Injector/Column

HP 5890 Series II cool on-column inlet and B (post mount) injector, and 0.53-mm i.d. column.

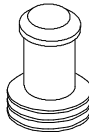

Action Required

Remove the needle guide (part number 19245-20670) from the septum nut base.



Septum Nut Base Assembly
19245-80520

HP 5890 Series II cool on-column inlet, B (post mount) injector configured to injector, and 0.32-mm to 0.25-mm columns.

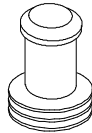

Use the small septum nut base assembly and 250/320 needle support.



Small Septum Nut
19245-80521

Needle Support, 250/320
G1513-61295

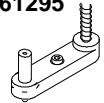

HP 5890A with cooling tower, B (post mount) injector, and 0.53-mm i.d. column.



Remove cooling tower and replace it with normal septum nut base assembly after aligning the bracket.



Septum Nut Base Assembly
19245-80520

Cooling Tower
19245-20540